



*Electric Guillotine Movable
Wall System*



The logo icon consists of three vertical rectangular bars of equal height. The leftmost bar is dark grey, the middle bar is olive green, and the rightmost bar is dark grey. The middle bar is slightly wider than the other two.

PANS SMART

Smart Solutions for Smart Spaces



PANSMART

Panel Type : Standard Panel
Operation Type : Semi-automatic
Trim Detail : Hidden Aluminium Profiles
Surface Coating : Wood+Glazed Module
Park Type : Double Roller suspension system
90° single row to panel rail axis

Acoustic Value : 44-52dB







Smart solutions for smart spaces.

What is it? Properties? Where is it used?

The Pansmart mobile partition wall system provides speed and flexibility while maintaining high quality. Pansmart is powered by low voltage electricity, has easy-to-mount panels, and guillotines that immediately shut vertical gaps, setting it apart from competing systems. The system is completely safe. The Pansmart semi-automatic system is ideal for complex room layouts with various elements and frequent motions. This saves time. Pansmart offers superior sound insulation and time-saving benefits. The system can be used in various settings, including conferences, meetings, hotels, businesses, and educational institutions.

- Smart Solution
- Automatic time-saving
- Comfort
- Automatic System

Semi-Automatic Shutdown	✓
Telescopic Panel	✓
Vertical Guillotine Lock	✓
In-Panel Door (Optional)	✓
Visible Profile Panel Thickness	10 cm
Hidden Profile Panel Thickness	12 cm
Maximum Height	1200 cm
Minimum Width	80 cm
Max Width	135 cm
Single reel/roller	✓
Double reel/roller	✓
Sound Insulation Values	45-60 (dB)
Weight per m2	35-60 kg
Anodized Static Painted Aluminum Profile	✓
In-panel glass modules	✓
Door glass modules	✓
Wood surface coating	✓
Fabric surface coating	✓
Glass surface coating	✓
Password or card pass system	X
Outdoor parking option	✓
Acoustic comfort enhancement option	✓
Acoustic barrier	✓
Insulation Tapes	✓

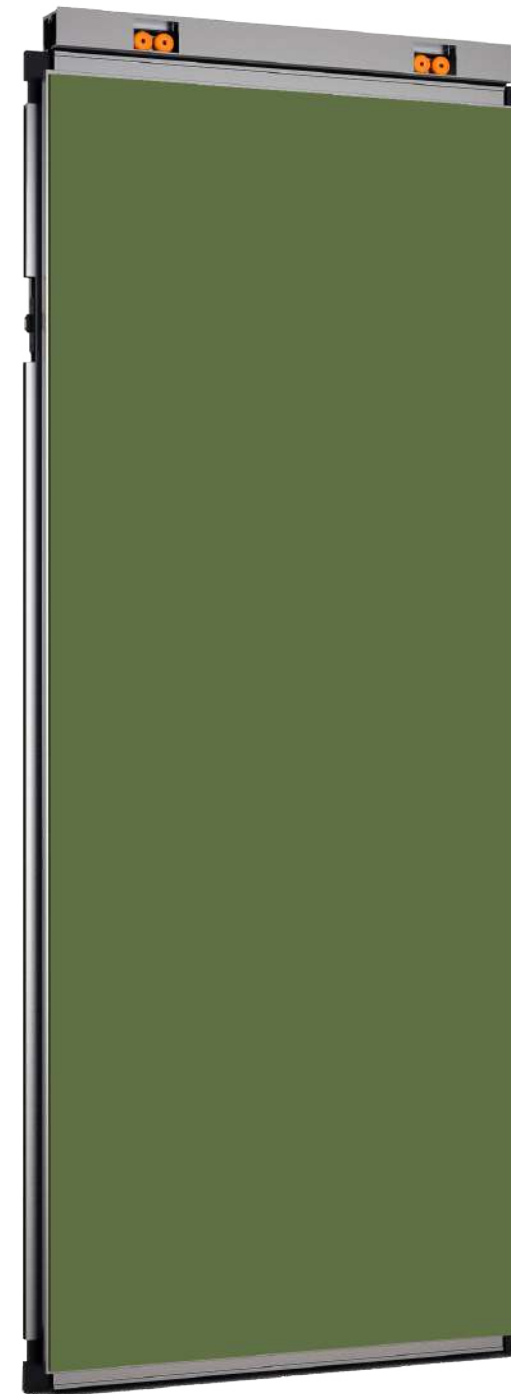



Panel Type	: Standard Panel
Operation Type	: Semi-automatic
Trim Detail	: Hidden Aluminium Profiles
Surface Coating	: Wood
Park Type	: Double Roller suspension system 90° single row to panel rail axis
Acoustic Value	: 48-60 dB

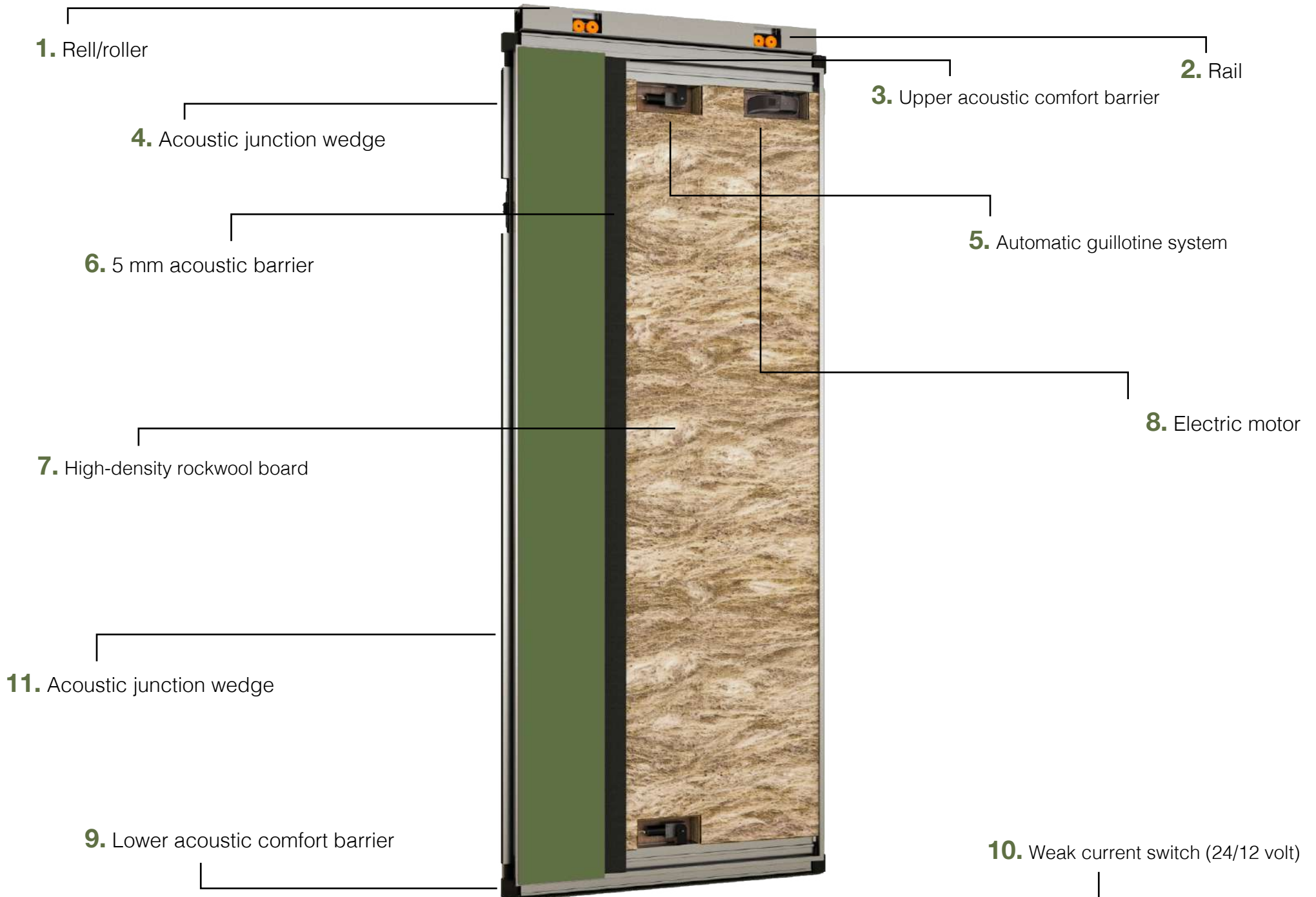

PANSMART

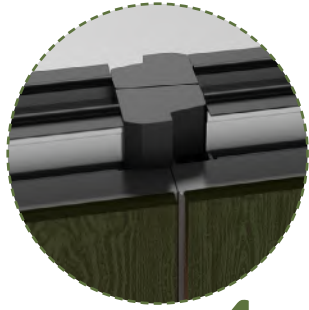

4b SYSTEM

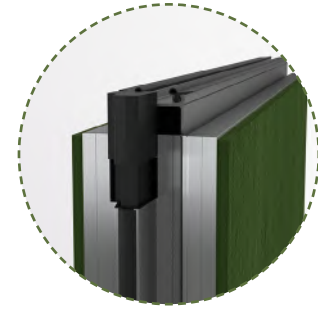

Upper vertical guillotine

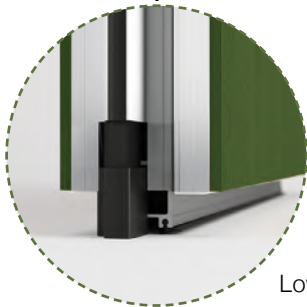
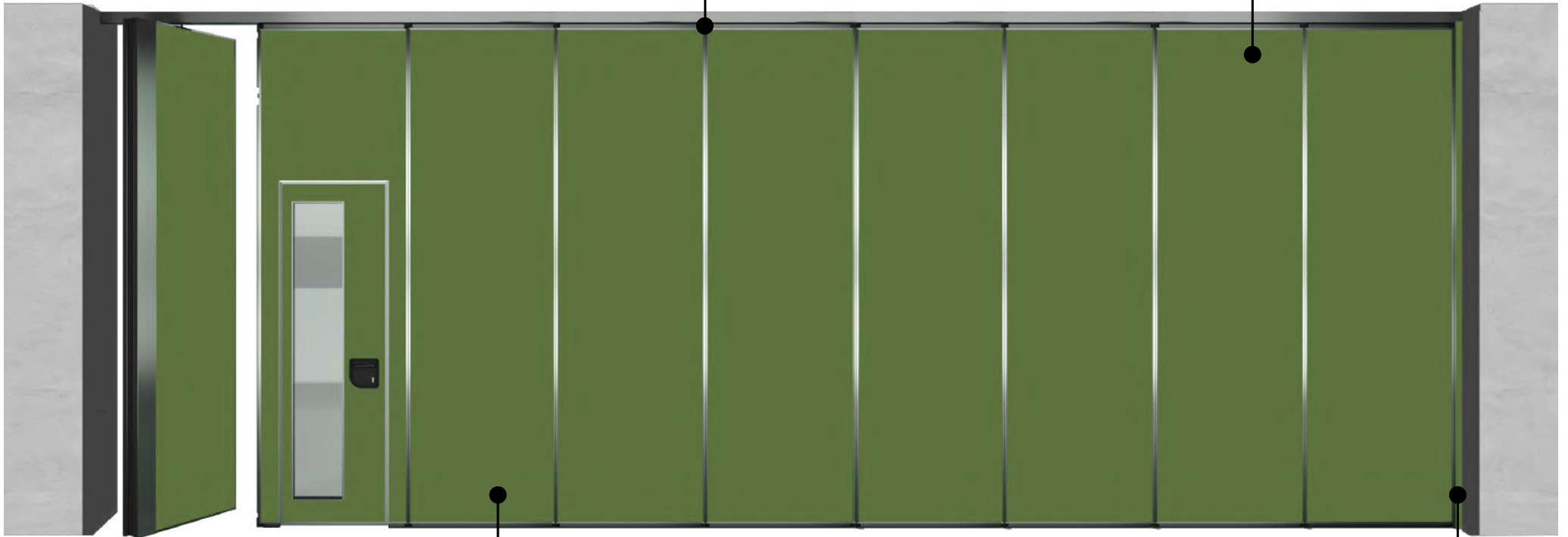

Lower vertical guillotine

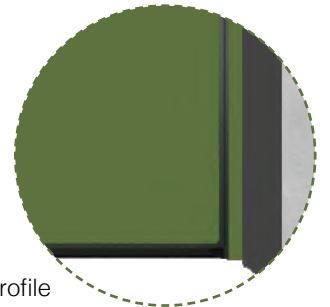

Start profile



Technical specifications (100 mm vertical Section)

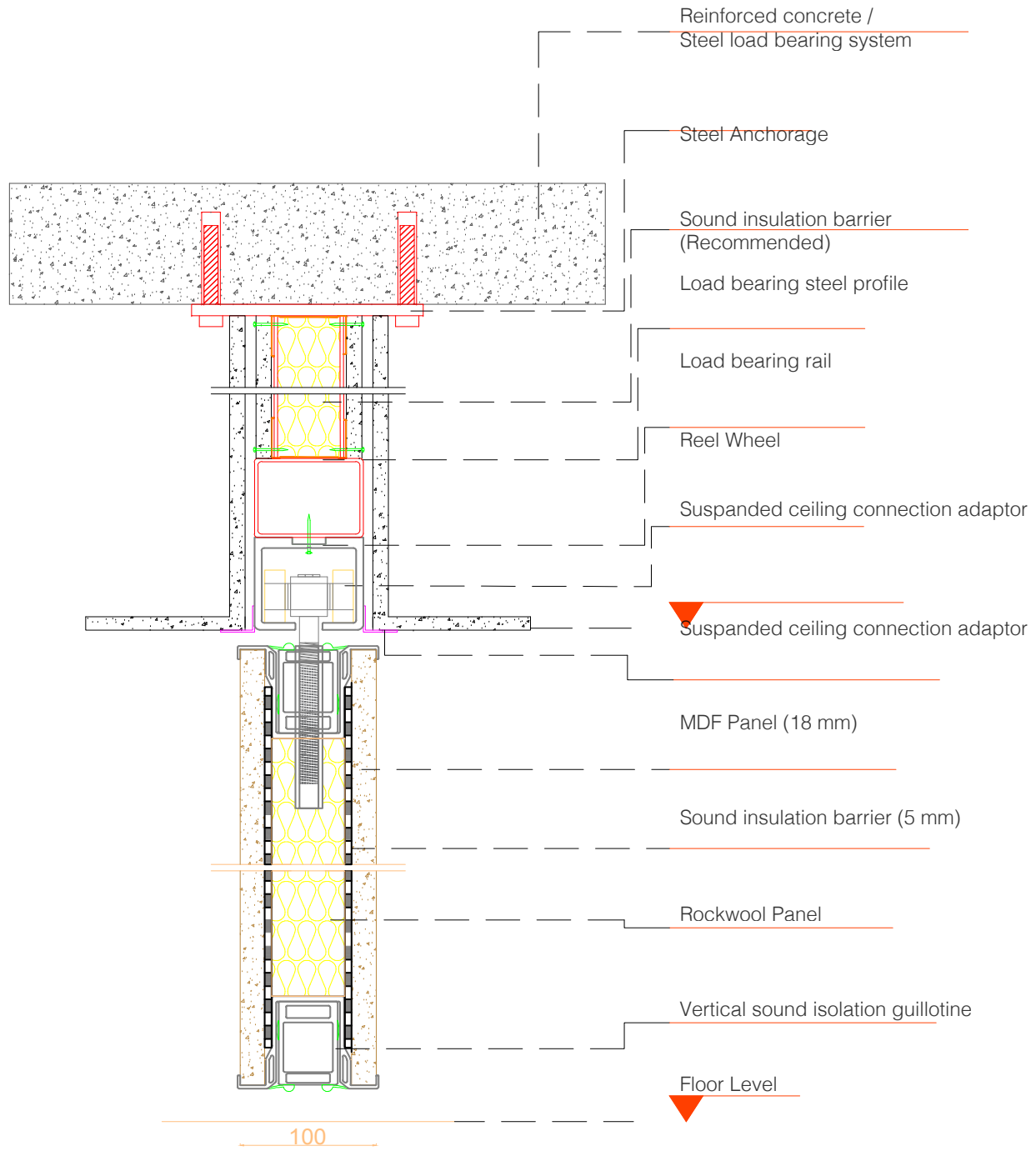

Technical specifications (100 mm horizontal Section)

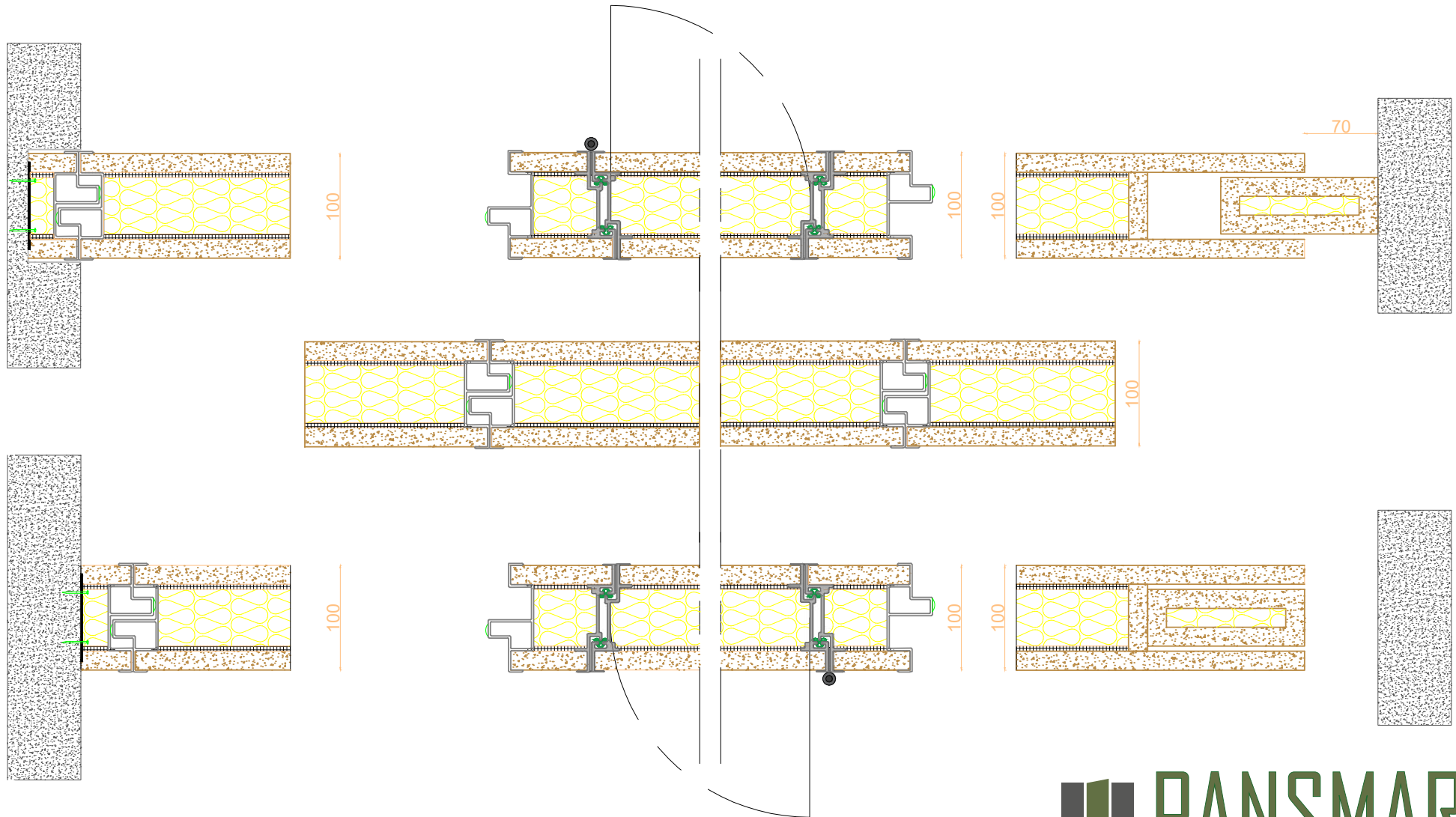

Technical specifications (117 mm vertical Section)

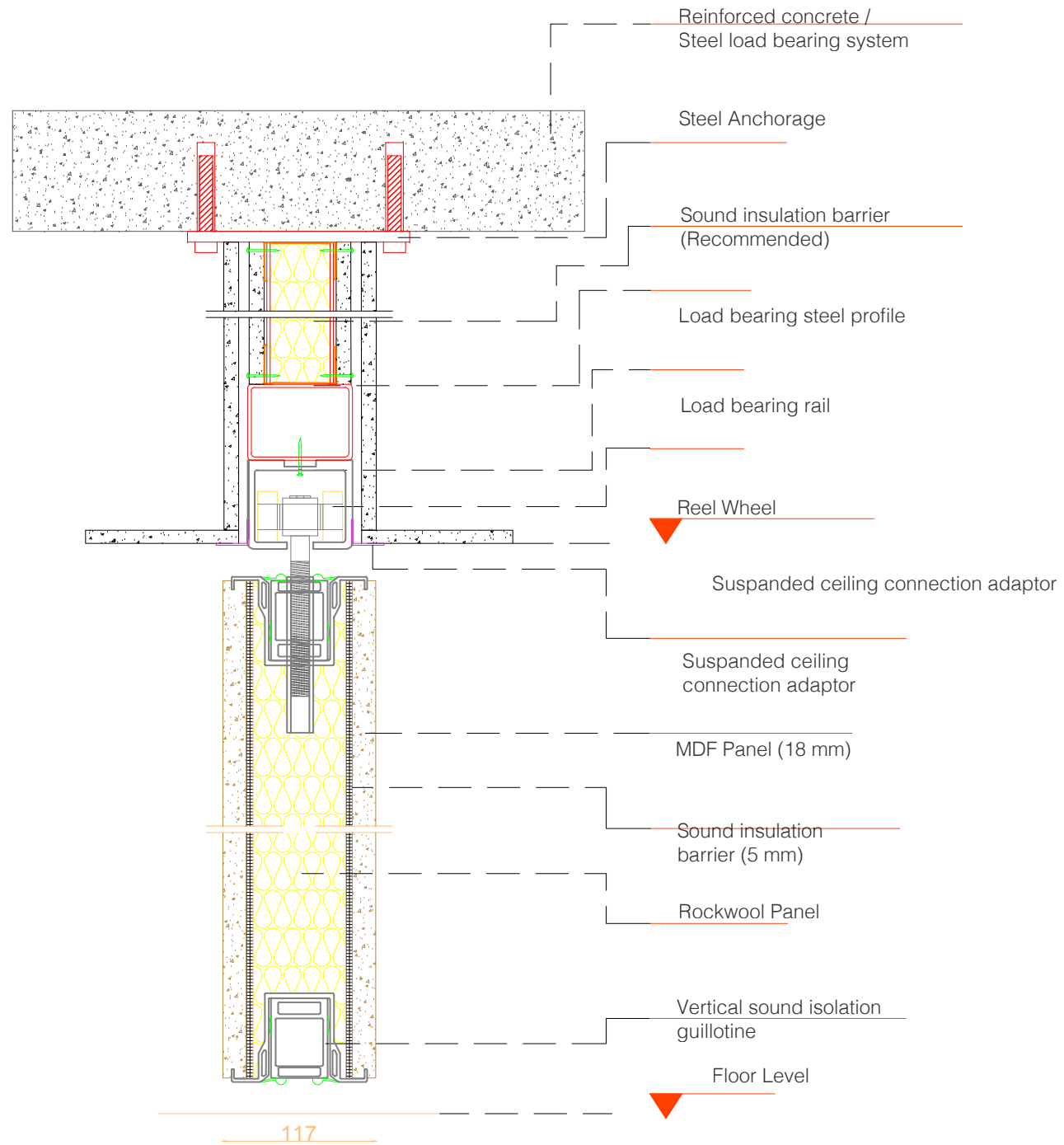

Technical specifications (117 mm horizontal Section)

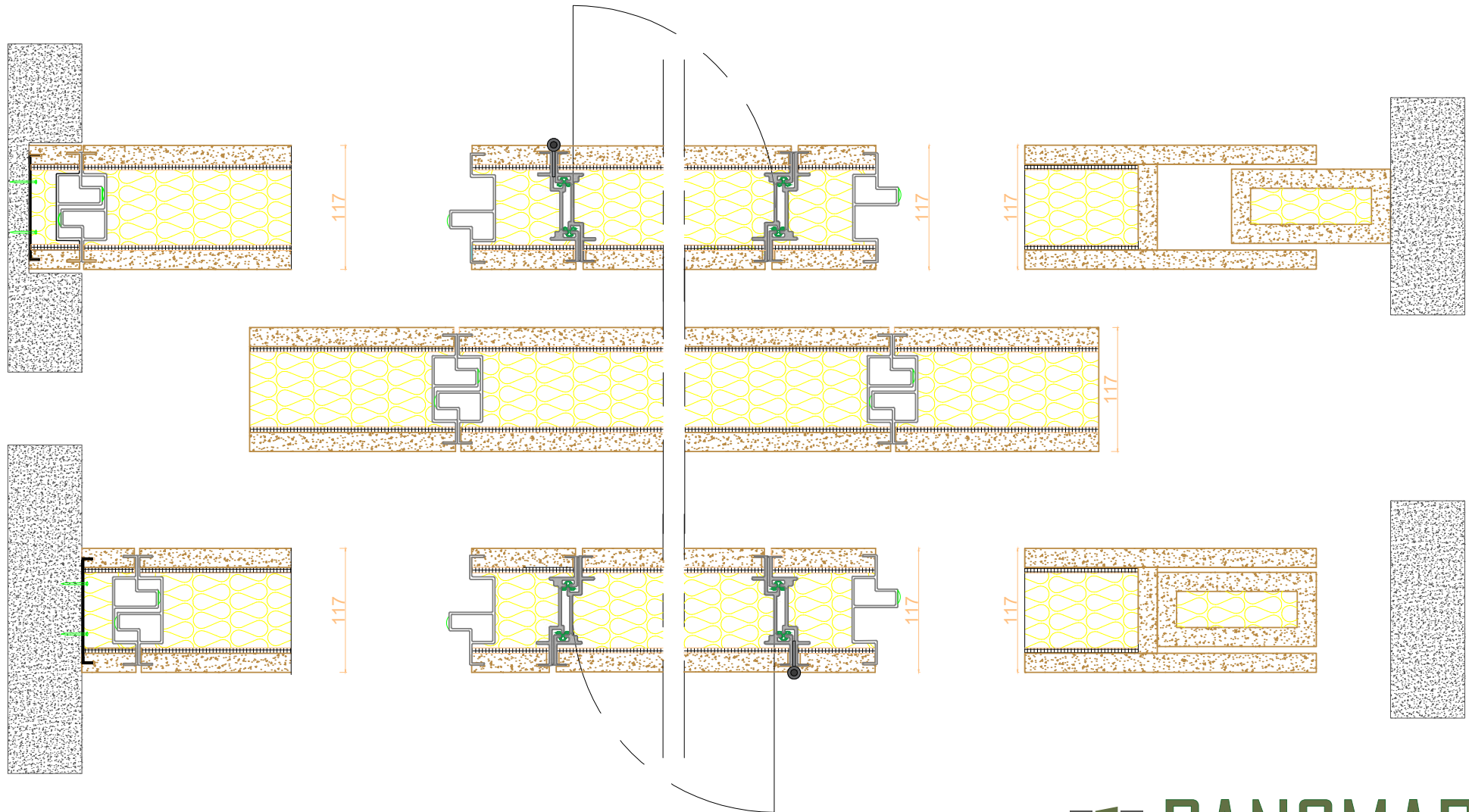

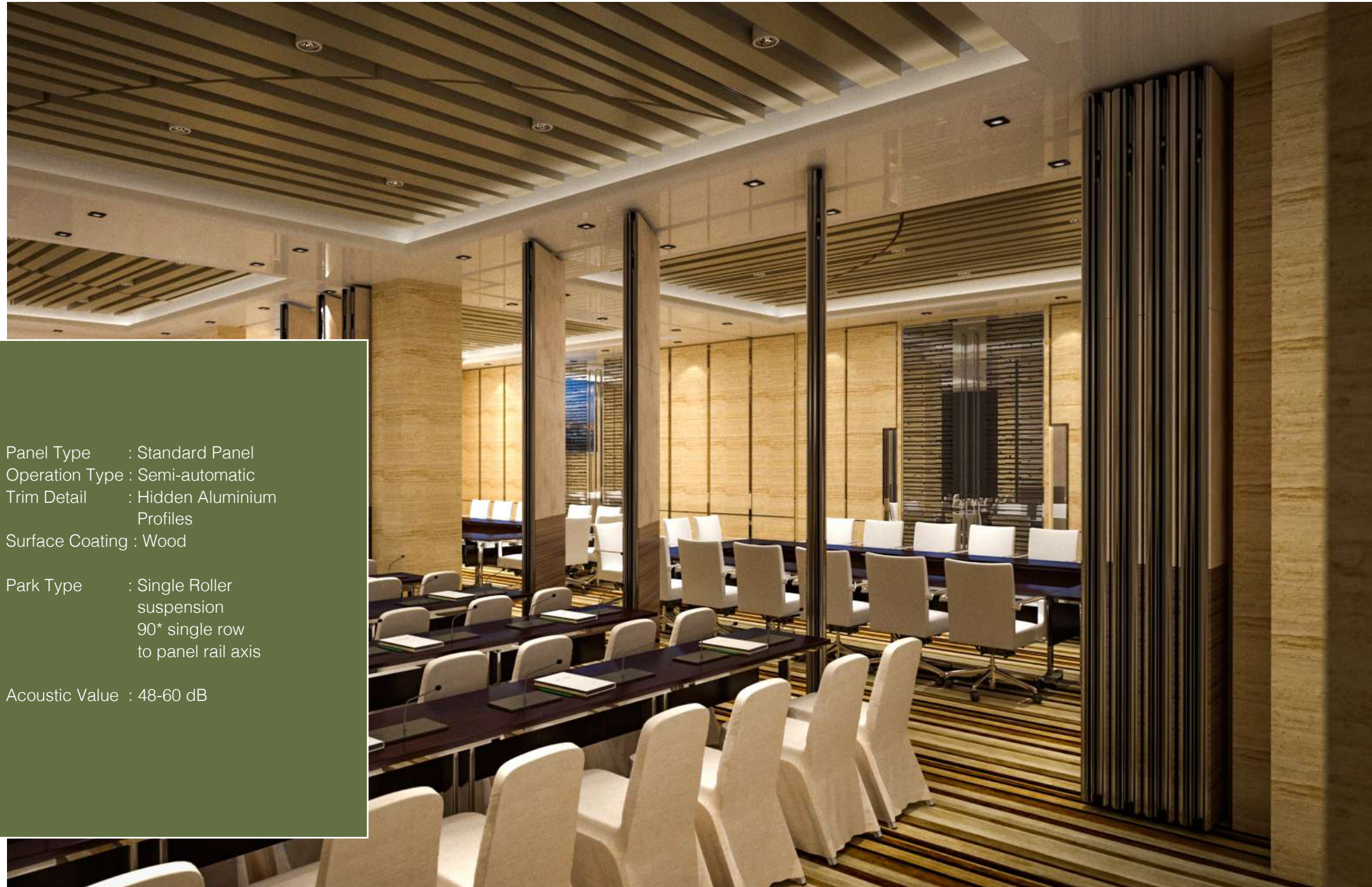

Panel Type : Standard Panel
Operation Type : Semi-automatic
Trim Detail : Hidden Aluminium
Profiles
Surface Coating : Wood

Park Type : Single Roller
suspension
90* single row
to panel rail axis

Acoustic Value : 48-60 dB







PANSMART SEMI-AUTOMATIC MOVING WALL TECHNICAL SPECIFICATIONS

Pansmart Semi-Automatic Movable Partition Wall System; Bend-resistant welded steel body profiles, special suspension elements suitable for the system, and multi-directional movable rollers suspended on roof-coded aluminum rails, which can move independently of each other and be stored in a certain place. It is a system consisting of filled modules with a thickness of 100/120 mm.

Each panel is moved manually and independently. The placement of the panels on the ceiling and the floor in a way that ensures impermeability is provided by a system that moves and controls all horizontal insulation profiles. The system is powered by electricity and provides automatic opening and closing of horizontal insulating profiles.

18 mm E1/V20 quality Concave and convex anodized aluminum profiles are found at the junction of modules consisting of melamine panels suspended from the body profile in two directions. The interior of the panels is covered with sound insulation in accordance with the sound insulation value required for both surfaces, and the interior spaces of the panels are filled with high-density rock wool.

The mechanical systems inside the module are driven by electric motors, and the black anodized aluminum insulating strips on the upper and lower lines of the modules move up and down, supplying energy to the surface, providing acoustic insulation and creating gapless walls. The system has TSE and ISO certificates.

System thickness	: 100 mm.
Total width	:
Total height	:
Carrier Profile	: Natural Anodized Aluminum, optionally static painted
Panel material	: 18 mm. E1/V20 High Quality Chipboard
Surface coating	: Melamine (Optionally acoustic coating, fabric, etc.)
Body profile	: Welded Steel Construction Resistant to Bending
Sound insulation	: 45 DB and 60 DB
Panel combination	: Natural Anodized Aluminum Profile
Edge detail :	: 8 mm vertically aluminum for visible trim, seamless wooden edge for hidden profile system
Insulation tapes	: Upper and lower Insulation Tape 25 mm aluminum
Electricity requirement	: 24/12 Volt
Mode of movement	: by hand
Control system	: Automatic
Rail	: Top Aluminum 100x90 mm natural anodized aluminum
Roller Type	: Single / Double Reel
Telescopic model	: 70 mm horizontal opening and closing movements should be possible.

PANSMART FUNCTION DESCRIPTION

Automatic opening and closing of all the horizontal profiles of the insulation and the telescopic panel, i.e, the operating speed of the wall system of the movable partition is supplied by the automatic motorized system. The transfer of the power supply between the panels is supplied by contact points on the side surfaces of the panels. The electric power for movement and control is provided by a plug-in power supply.

The movement of insulating profiles is controlled by a central switch (control button). All functions are monitored by a microprocessor. The panels have a double insulating profile in the upper and lower part, applying constant pressure to compensate for disturbances on the floor and on the ceiling. The spring profile in the semi-automatic engine system applies pressure continuously to these profiles. To provide maximum vertical sound insulation, the black profile at the end of the aluminum profiles is made of polyurethane material. Vertical profiles, on the other hand, are made of aluminum to provide maximum sound insulation and stability. The size of the lower and upper insulation profiles when opened is 20 mm. The minimum contact pressure is 500N.

The mechanical systems inside the module are driven by electric motors, and the black anodized aluminum insulating strips on the upper and lower lines of the modules move up and down, supplying energy to the surface, providing acoustic insulation and creating gapless walls. The system has TSE and ISO certificates.

Panel connection

The panels are connected to each other by locking concave and convex aluminum profiles vertically.

In the last panel of the division system, there is a special telescopic panel with an extensible part. This piece continues throughout the height of the panel height. The telescopic panel, as in other panels, is composed of an 18 mm natural wood-coated chipboard, which the employer/controller and the author of the project will consider appropriate and has the E1 feature.

Each panel is suspended from one or two points by rollers that provide movement within the aluminum rail suspended from the ceiling. The hangers are connected to the panel with shock-absorbing rods and impact-resistant rods for safe movement.

Each panel has an adjustable feature to compensate for any sagging in the ceiling. It is not necessary to open the ceiling cavity or open the inside of the panel. When there is a deterioration of the panel that requires replacement, the panels can be easily modified without disturbing the system thanks to its hooked functionality. The rail is long-lasting and maintenance-free. Intersections, T-joints, and corner elements are welded together.





PANSMART



TurkoWall 

mobile partition systems

— turkowall.com —

